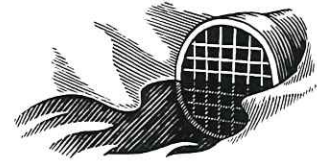


## Davison County Drainage

200 E. 4<sup>th</sup> Ave.  
Mitchell, SD 57301-2631  
Phone (605) 995-8615



### Davison County Drainage Board Agenda

The following is the agenda for the Davison County Drainage Board meeting to be held on Tuesday, July 15, 2025, in the Davison County Commissioners' Room in the North Offices Building, 1420 N Main St., Mitchell, SD 57301.

1. Call to order by Chairman Larson at 7:00 PM.
2. Roll Call
3. Meeting expectations.
4. Consider the agenda.
5. Declare conflicts of interest.
6. Consider the minutes from the December 17, 2024, meeting.
7. Public comment and citizen complaints for items not on the agenda-no action will be taken.
8. Shannon Hutterian Brethren, Inc. has applied to the Davison County Drainage Commission to recommend granting a drainage permit. This request is pursuant to Article 2 of the Davison County Drainage Ordinance as adopted on 8/27/2013. The property drained, or involved in the project, is legally described as SE1/4, less H-1, of Section 13, T 101 N, R 60 in Davison County (10000-10160-134-00). The outlet will be in the NE1/4 of Section 19, T 101 N, R 59 in Hanson County (101-59-019-001-000-01).
9. Administratively Approved Applications
  1. Gerlach, Roger & Richard
10. Miscellaneous items.
11. Set time and date for the next drainage meeting – August 19, 2025 @ 7:00 P.M.
12. Adjournment.

*Karen Wegleitner*

Karen Wegleitner  
Deputy Director of Planning & Zoning/EM/Drainage  
Davison County

[karenw@davisoncounty.org](mailto:karenw@davisoncounty.org)

605-995-8615

605-299-6059

**DRAINAGE BOARD**  
**December 17, 2024**

**CALL TO ORDER**

Chairman Larson called the regular meeting of the Davison County Drainage Board to order at 7:00 p.m. Auditor Wingert took roll call as follows: Members of the Board present were Jay Larson, Chet Edinger, Jerry Buchholz, Gregg Bult, Mark Klumb, Denny Kiner, & Chris Nebelsick (called in at 7:07 P.M.). Members Absent were none. Ex-Officio members present were Drainage Deputy Administrator Wegleitner. Ex-Officio members absent were Drainage Administrator Bathke, Highway Superintendent Weinberg, and Director of Equalization Vissia.

Guests – Travis Gerlach, Frank Luzack, and Curtis Mueller.

**MEETING EXPECTATIONS**

Chairman Larson recited expectations of the meeting.

Each permit will be considered based on a checklist of items required in accordance with the Davison County Drainage Ordinance and SDCL 46A-10A. The checklist is on file in the Davison County Auditor's office and the Drainage Administrator's office.

**APPROVE AGENDA**

Motion by Gregg Bult, second by Chet Edinger to approve the agenda for the December 17, 2024, meeting. All members voted aye. Motion carried.

**DECLARE CONFLICTS OF INTERESTS**

Chairman Larson asked for any conflicts of interest. Mark Klumb recused himself due to being an abutting neighbor to item # 8, Roger Gerlach's drainage application.

**APPROVE MINUTES**

Motion by Mark Klumb, second by Chet Edinger to approve the minutes of the September 17, 2024, meeting. All members voted aye. Motion carried.

**PUBLIC INPUT & CITIZEN COMPLAINTS**

Chairman Larson asked for any public input for items not on the agenda and reminded all in attendance that no action would be taken.

Frank Luzack spoke about Loren VanOverschelde's drainage application administratively approved on May 21, 2024. He stated Mr. VanOverschelde's project can't go on his land without his approval.

**ROGER GERLACH DRAINAGE VIOLATION**

Motion by Chet Edinger, second by Jerry Buchholz, based on findings, to grant a drainage permit to drain the following, the N ½ of the NW ¼ of Section 30, T 101 N, R 61 into Tobin Township Road ditch.

The applicant started filling in the field ditch without a drainage permit. The applicant explained water comes from the west and creates erosion, which causes the land to be unfarmable. The plan would be to fill in the field ditch and clean the Tobin Township Road ditch south of the property to help with farming.

Application received: December 2, 2024.

Applicant and necessary neighbors notified: December 3, 2024.

Published in the paper: December 7, 2024.

Deputy Administrator Wegleitner explained there were no calls from abutting property owners or other residents.

The Planning & Zoning Office received complaints of a drainage ditch being filled in on Roger Gerlach's property. Upon investigation, we found this to be correct and the work was being done without a drainage permit. Travis Gerlach was present and explained they filled in the ditch to make it farmable and didn't realize he needed a permit. He stated they bought the property a year ago and thought it was neglected work. He explained water flows from the west into his field instead of the road ditch as the culverts at 266<sup>th</sup> St. and 400<sup>th</sup> Ave. can't handle the water and create erosion which makes the ground unfarmable. He has plans to clean out the Tobin Township Road ditch. Travis explained to the board where the water flows on his property and when it goes into the road ditch.

Curtis Mueller from Tobin Township was present. He stated they have no issues with anyone trying to improve their property, but they would like to be informed so they can work together as some of it will affect the Township. Curtis explained they didn't get into any yellow dirt and all they did was maintenance. He explained the corner of 266<sup>th</sup> and 400<sup>th</sup> needs more maintenance but it's a catch 22 on putting more pipes in or increasing pipe sizes.

The board asked about any neighbors' concerns. I had no calls or letters with concerns. Mark Klumb, an abutting neighbor, stated we will see with the next rain how it all flows. He knows ditches weren't made for water, but water shouldn't be flowing in and out of the ditch as something is wrong with the ditch. Ditches shouldn't be higher than the ground. The board approved the permit with no other fees since he paid a \$500 fine and Tobin Township is okay with the work.

Board members were given a few minutes to review the items to consider prior to a decision, in accordance with Section 2:05 of the Davison County Drainage Ordinance. The items were placed on the screen for all to view.

A roll call vote was taken as follows. Buchholz – aye, Bult – aye, Edinger – aye, Larson – aye, Kiner – aye, Nebelsick (call-in) - aye, Klumb – abstain. Motion carried.

### **ADMINISTRATIVELY APPROVED APPLICATIONS**

Deputy Administrator Wegleitner informed the board there were two Administratively Approved Applications since the last meeting.

An application for Shannon & Michelle Klumb was administratively approved on November 1, 2024. The legal description of the land to be drained is the N ½ and the SE ¼ of the NW ¼ of Section 27, T 101 N, R 61 in Davison County, except the NE ¼ of the NE ¼ of the NW ¼. The drainage plan is to install approximately 2,400' of 10", 1,450' of 6", and 24, 545' of 4" drain tile, which will outlet into a

blue line to the north, which will drain into the Twelve Mile Creek. The inlet and outlet will remain on the applicant's land. This is for information only; no vote is required.

An application for Nicole Johnson & Scott Estabrook was administratively approved on November 18, 2024. The legal description of the land to be drained is the SW ¼ of Section 26, T 103 N, R 62 in Davison County with the outlet on the same property. The drainage plan is the removal of silt and debris from the existing watercourse to remove a small amount of ponding in non-wetland areas. The original depth and capacity of the drainage will not be exceeded, and the path of the flow will not be altered. This is for information only; no vote is required.

#### **MISCELLANEOUS ITEMS**

None.

#### **SET DATE AND TIME FOR NEXT MEETING**

Chairperson Larson set January 21, 2025, at 7:00 p.m. as the next meeting date and time.

#### **ADJOURN**

At 7:42 p.m., Chairman Larson adjourned the meeting.

#### **ATTEST**

---

Kathy Wingert, Auditor

---

Jay Larson, Chairman

Publish Once  
Approximate Cost



Davison County Planning & Zoning  
200 E. 4<sup>th</sup> Ave.  
Mitchell, SD 57301-2631  
Phone (605) 995-8615  
Fax (605) 995-8618



## Appendix A DAVISON COUNTY DRAINAGE APPLICATION

### I. Applicant(s):

Permit (Parcel) Number: 10000-10160-134-00

Name: Shannon Hutterian Brethren, Inc.

Date Filed with Register of Deeds: \_\_\_\_\_

Address: 43945 235<sup>th</sup> St.  
Winfred, SD 57076

Date received: 6/20/25

Phone: 605-270-7421

Email: m1969mark@yahoo.com

Submitting Application to: ☒ Drainage Board ☐ Administrator for Administrative Approval

NOTE: This application must be accompanied by a detailed site plan, showing:

1. The location of the proposed drainage system; to include the inlet, outlet, & all drains.
2. The direction of the water flow.
3. The destination of water from the outlet, up to 1 mile.

Landowners affected will be notified by the Drainage Administrator. The Township Board Chairman will also be notified and a copy of this application will be attached. For Administrative Approval, provide waivers (Appendix B) from landowners  $\frac{1}{2}$  mile upstream, 1 mile downstream, and a  $\frac{1}{4}$  mile buffer on both sides of the drainage area.

List of all landowners  $\frac{1}{2}$  mile upstream, 1 mile downstream, and  $\frac{1}{4}$  mile buffer on both sides:

NAME	ADDRESS	PHONE
1. <u>Jared &amp; Raquel Nesheim</u>	<u>512 E. Ash St., Ethan, SD 57334</u>	
2. <u>Bonnie McBrayer</u>	<u>P.O. Box 70, Ethan, SD 57334</u>	
3. <u>Dan &amp; Paula Schmidt</u>	<u>41171 264<sup>th</sup> St., Ethan, SD 57334</u>	
4. <u>Schoenfelder Family Limited</u>	<u>25811 409<sup>th</sup> Ave., Mitchell, SD 57301</u>	
5. <u>Ryan &amp; Amy Storm</u>	<u>39948 266<sup>th</sup> St., Mt. Vernon, SD 57363</u>	
6. <u>Town of Ethan</u>	<u>P.O. Box 25, Ethan, SD 57334</u>	
7. <u>Kelly Tobin</u>	<u>41140 265<sup>th</sup> St., Ethan, SD 57334</u>	
8. <u>Kelly &amp; Kimberly Goldammer</u>	<u>26488 412<sup>th</sup> Ave., Ethan, SD 57334</u>	
9. <u>Riggs Farms Inc.</u>	<u>41304 264<sup>th</sup> St., Ethan, SD 57334</u>	
10. <u>Joseph Weiland</u>	<u>41208 Hwy 42, Ethan, SD 57334</u>	
11. <u>Tristan Scott</u>	<u>305 S. 6<sup>th</sup> St., Ethan, SD 57334</u>	

- |  |  |
|--|--|
| 12. <u>Randall &amp; Nancy Schoenfelder</u>        | <u>420 S. 6<sup>th</sup> St., Ethan, SD 57334</u>      |
| 13. <u>Bruce Graves</u>                            | <u>900 W. 15<sup>th</sup> Ave., Mitchell, SD 57301</u> |
| 14. <u>Gordon T. Stahl Trust</u>                   | <u>25823 407<sup>th</sup> Ave., Mitchell, SD 57301</u> |
| 15. <u>Tom &amp; Alison Freidel</u>                | <u>41632 270<sup>th</sup> St., Ethan, SD 57334</u>     |
| 16. <u>Bryan Sanderson</u>                         | <u>26525 413<sup>th</sup> Ave., Ethan, SD 57334</u>    |
| 17. <u>Robert &amp; Linda Henglefeldt</u>          | <u>26676 411<sup>th</sup> Ave., Ethan, SD 57334</u>    |
| 18. <u>William A. Werning Trust</u>                | <u>P.O. Box 220, Mitchell, SD 57301</u>                |
| 19. <u>New Elm Springs Hutterian Brethren Inc.</u> | <u>41844 269<sup>th</sup> St., Ethan, SD 57334</u>     |
| 20. <u>Lyle &amp; Dawn Lingemann Trust</u>         | <u>26558 412<sup>th</sup> Ave., Ethan, SD 57334</u>    |
| 21. <u>Hanner &amp; Adriahna Tilberg</u>           | <u>41159 262<sup>nd</sup> St., Ethan, SD 57334</u>     |
| 22. <u>Ryan Guericke</u>                           | <u>26539 414<sup>th</sup> Ave., Ethan, SD 57334</u>    |

*BY SIGNING THIS APPLICATION, AS OWNER OF RECORD OF THE FOLLOWING PARCEL OF LAND FOR A DRAINAGE APPLICATION, ALLOWS PERMISSION TO THE DESIGNATED DRAINAGE ADMINISTRATOR TO ENTER UPON THE FOLLOWING PROPERTIES, FOR THE PURPOSE OF INSPECTION AND OBTAINING INFORMATION FOR THE ADMINISTRATIVE OR DRAINAGE COMMISSION'S DECISION. (INITIALS MW)*

## II. Location

- Location of land to be drained:

SE ¼, less H-1, of Sec 13 Twp 101 Rge 60 County Davison (10000-10160-134-00)

- Location of outlet end of proposed drain:

NE ¼ of Sec 19 Twp 101 Rge 59 County Hanson (101-59-019-001-000-01)

Name or description (if any) of any watercourse, lake, slough, draw, natural drain-way, stream, creek, river, drain or ditch that is involved in this application: The outlet will drain into Twelve Mile Creek, which is a 3-dot blue line creek.

- Any structures unable to be altered in the drainage path: None.

## III. Description of Proposed Drainage System:

### ☐ Open Drainage Ditch

- Approximate size of area being drained (Acres): \_\_\_\_\_
- Elevation change from the inlet to the outlet (Feet): \_\_\_\_\_
- Bottom Width (Feet): \_\_\_\_\_
- Side Slope (Feet): \_\_\_\_\_
- Maximum Cut (Feet): \_\_\_\_\_
- Any boring under roadway: \_\_\_\_\_
- Explanation of Drain Design: \_\_\_\_\_

### ☒ Closed Drainage Ditch (Underground drain tile)

- Approximate size of area being drained (Acres): 157.40 Acres
- Elevation change from the inlet to the outlet (Feet): Inlet: 1,329.2' to Outlet is in Hanson County.
- Length of Solid Drain (Feet): 5,836.21'
- Length of Perforated Drain (Feet): 123,444.72'
- Total Length of all Drain (Feet): 129,280.93'
- Diameter(s) of Drain (Inches): 4", 6", 8", 10", 12", & 15"
- Any boring under roadway: Yes. Have SD DOT approval. Utility Permit included.
- Explanation of Drain Design: Approximately 129,280.93' of 4", 6", 8", 10", 12" & 15" perforated & solid drain tile with one outlet into Twelve Mile Creek. The water will eventually merge with the James River.



☐ Other Type of Drainage Ditch:

- Approximate size of area being drained (Acres): \_\_\_\_\_
- Elevation change from the inlet to the outlet (Feet): \_\_\_\_\_
- Any boring under roadway: \_\_\_\_\_
- Explanation of Drain Design: \_\_\_\_\_

\_\_\_\_\_  
\_\_\_\_\_  
\_\_\_\_\_

IV. **South Dakota One Call Locate Date:** 48 hours prior to digging

V. **General Considerations:**

State any facts or reasons you believe are pertinent to the proposed drainage system that may assist the Administrator or Board in consideration of this application.

\_\_\_\_\_  
\_\_\_\_\_  
\_\_\_\_\_

VI. **Required Signatures:**

If the drainage system allows water to enter a Road Right of Way, a signature from the appropriate Road Authority is also required. This includes Township, County, and State roads.

\_\_\_\_\_  
Road Authority Signature

*Shannon Muttarian Brethren Inc*  
*by Mark L. Wipf*

\_\_\_\_\_  
Applicant/Owner Notarized Signature

STATE OF SOUTH DAKOTA

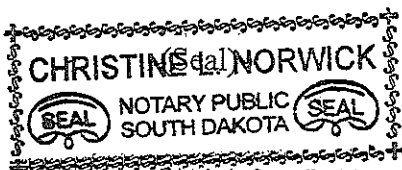
)  
) SS

COUNTY OF DAVISON

)

On this 20 day of June, 2025, before me, the undersigned officer, personally appeared Mark L. Wipf, known to me or satisfactorily proven to be the person whose name is subscribed to the within instrument and acknowledge that he executed the same for the purposes therein contained.

In Witness Whereof, I hereunto set my hand and seal.



*Christine L. Norwick*  
Notary Public

5/5/2028  
My Commission Expires



STATE OF SOUTH DAKOTA

)  
) SS  
)

In Witness Whereof, I hereunto set my hand and seal.

## My Commission Expires

STATE OF SOUTH DAKOTA

)  
) SS  
)

In Witness Whereof, I hereunto set my hand and seal.

## My Commission Expires

**VII. Administrator or Drainage Board Decision:**

This Application to drain is hereby:

☐ Approved

☐ Disapproved

Date: \_\_\_\_\_

Attached hereto and incorporated herein are special conditions on this permit:

---

---

---

---

---

\_\_\_\_\_  
Planning & Zoning Administrator

\_\_\_\_\_  
Drainage Commission Chairperson

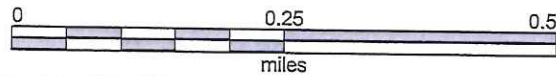
\_\_\_\_\_  
County Auditor

Name

8" inlet 4" inlets around here



15" outlet



Client: Shannon Colony, solid -	12 inch road bore	153.73 ft
Name: Davidson Co. Rome twp sec.	Tile 4	115578.47 ft
	Tile 6	4709.39 ft
	Tile 8	2201.07 ft
	Tile 10	955.79 ft
solid -	Tile 12	4110.08 ft
solid -	Tile 15	1572.40 ft





Farm: 4330

Tract: 9079

Geographic County: Davison

Administrative County: Hanson

Customer: Shannon HBI

# Certified Wetland Determination



Map Creation Date: 3/21/2024

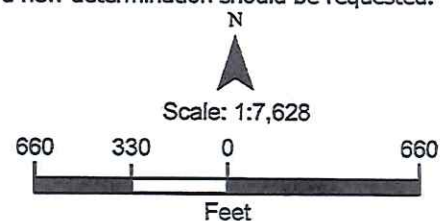
SE1/4, section 13-101-60

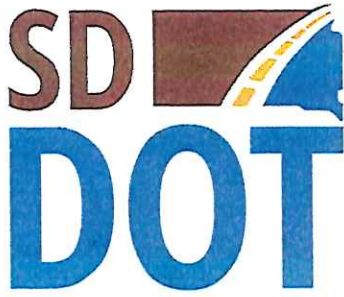


Image:

Site_Drainage_Lines	FW
Drainage Ditch, Pre-1985	NW
Site_CWD	PC
CWD Default	AW

This certified wetland determination has been conducted for the purpose of implementing the wetland conservation provisions of the Food Security Act of 1985, as amended. No determination is made or implied in the unlabeled portions of the map. If land manipulations are planned in unlabeled areas which do not have previous determinations, a new determination should be requested.





## Department of Transportation

Mitchell Area Office

PO Box 1206

Mitchell, SD 57301-1206

PHONE: 605.995.8120

June 19, 2025

Mark Wipf  
Shannon Colony

RE: Utility Permit on Hwy 42 for installation of drain Tile - MRM 304.21

Dear Mr. Wipf

Enclosed is an approved utility permit for the installation of the drain tile crossing on Hwy 42. The permit will only be valid if the below conditions are met.

- Provide the DOT with a copy of the approved drainage permit from Hanson County.
- Provide permissions from adjacent landowners where tile will cross their properties.
- A completed Revocable Occupancy Permit must be signed by the Landowner and DOT prior to the installation of the drain tile.

Should you have any questions or wish to discuss this further, please contact this office.

Sincerely,

Jay Peppel, PE  
Mitchell Area Engineer  
South Dakota Department of Transportation

A handwritten signature in blue ink, appearing to read "Nathan Maeschen".

Nathan Maeschen  
Transportation Project Manager





# DOT-200: Application for Utility Permit

South Dakota Department of Transportation, Office of Operations Support  
700 E. Broadway Ave., Pierre, SD 57501-2586 (605) 773-3571

By using this form  
you are agreeing to  
our terms of use.  
Please read:

Highway no. 42 County Huachuca Approximately 1.5 miles N ☐ S ☐ E ☒ W ☐

from Ethan for construction of Drain tile  
(city or well-defined point) (type of utility facility)

Begin legal description SW 1/4 T10N R54W sec 18 End legal description NW 1/4 T10N R54W sec 19

Intended usage or rating Non- Pressurized Drain

Cable size/type \_\_\_\_\_ Casing size/type \_\_\_\_\_

Outsize pipe diameter \_\_\_\_\_ Maximum pipeline operation pressure NA (Gravity Flow)

Minimum depth, cable or pipeline (under rural highway 48") ☒ (under curb/gutter 24") ☐ (all other areas 36") ☐ (overhead) ☐

Method of installation Directional Bore

Approximate construction dates: Start \_\_\_\_\_ Finish \_\_\_\_\_

Special conditions \_\_\_\_\_

I, the undersigned, request permission to construct and maintain a utility facility on public right of way at the above location and as shown on the attached layout sheet and in accordance with provisions of Administrative Rules of South Dakota (ARSD) 70:04:05. In consideration for this permission, I agree to abide by all conditions of said rules, and in addition, the following:

1. This Utility Permit does not replace any other permit, license or other approval that may be required by any other entity holding a property interest in the right of way, including but not limited to any tribal government, the Office of School and Public Lands, the U.S. Forest Service and the Bureau of Indian Affairs. The issuance of this Utility Permit does not relieve the applicant of the obligation to obtain any other approvals that might be required for use of the highway right of way for utility purposes. The applicant is solely responsible for investigating whether additional approval is required and complying with any other applicable requirements. If the applicant fails to secure all necessary approvals or comply with all applicable requirements, this permit is of no effect whatsoever, and the South Dakota Department of Transportation (SDDOT) may, at the applicant's sole expense, cause the immediate removal of the utility facilities.
2. To furnish all materials, labor, incidentals and pay all costs involved with the construction and maintenance of the utility facility. To perform approved open-cut trench operations in accordance with current SDDOT Open Cut Method of Utility Installation or Repair, ARSD 70:04:05, Appendix A. To restore any damaged portions of the roadway and right of way to equal or better conditions than existed prior to beginning work covered by the permit. To not install a utility over the top of any highway drainage structure. To permanently mark above-ground pedestals/facilities with metal flags or markers located at least 48" above ground.
3. If deemed necessary by the SDDOT, to move or alter the utility installation in any way due to maintenance or highway construction within its present right-of-way width, the alteration will be accomplished by the owner without cost to the State.
4. To provide protection to highway traffic during construction and maintenance by use of proper signs, barricades, flag persons and lights as prescribed in the current edition of the *Manual on Uniform Traffic Control Devices*.
5. Workers are required to wear high-visibility safety apparel intended to provide conspicuity during both daytime and nighttime usage, and meeting the Performance Class 2 or 3 requirements of the ANSI/SEA 107-2004 publication "American National Standard for High-Visibility Safety Apparel and Headwear."
6. To indemnify and how the State of South Dakota, the SDDOT, its officers, agents and employees harmless, from and against any and all actions, suits, damages, liability or other proceedings of any kind or nature brought because of any injuries or damage received or sustained by any person or property on account of the use or occupancy of highway right of way designated in this application.

Company M+S Drainage Date \_\_\_\_\_ Email address mnsdrainage@gmail.com  
Address P.O. Box 156 City Pringle State IA Zip 51245 Phone (712) 540-1294

By Jim Stofferan Print or type Jim Stofferan Title President  
Mark Wipf Shannon Colony

TO BE COMPLETED BY THE SOUTH DAKOTA DEPARTMENT OF TRANSPORTATION

Project 042-252 Milepost 304.21 Maintenance Unit 252

1. Prior to commencing construction and upon completion of work the applicant shall notify  
Charles Goldammer at Mitchell Phone 605-770-7389
2. Special conditions A Revocable Occupancy Permit will be required prior to the installation of the Tile within the ROW.
3. Failure to construct and maintain the utility facility in accordance with the provisions of this permit will automatically render this permit null and void, and constitute grounds for its removal and/or full restoration of the site at the applicant's expense.

Recommended \_\_\_\_\_ Date \_\_\_\_\_ Bridgehead Design \_\_\_\_\_ Date \_\_\_\_\_  
Approved \_\_\_\_\_ Area Engineer \_\_\_\_\_ Date 6/18/25  
Approved \_\_\_\_\_ Region Engineer \_\_\_\_\_

This permit to construct and maintain a utility facility  
is granted subject to all conditions as herein stated.

Hanson County

Date:

6-24-2025

Drainage Permit

Permit#

25-14

Paid

✓ CK# 422

Name Shannon Hutterian Brethern <sup>cluc.</sup> by Landowner

Address 43952 235 Street Winfred, d. Dak. 57076

Phone # 605-485-2236 Cell# 605-270-7421 Contact Shannon

IN ALL CASES, THIS APPLICATION MUST BE ACCOMPANIED BY A COLOR  
MAP SHOWING THE PROPOSED DRAINAGE AREA.

Land of Land to be drained: (Section Legal) SE 1/4 Sect 13-101-60

Area of Land to be drained: 157.40 acres

Location of Outlet End of Drain: (describe to nearest 40 Acres,  
e.g. NE1/4 NE1/4 of 11-103-58 Jasper) \_\_\_\_\_ and  
Show on Map

2 Township signatures (Required) 1 Aaron Reiss

" " " 2 Michael Hoffman

Nearest Named Downstream Watercourse:

Names of Downstream Landowners between outlet and nearest blue  
line (A "Drainage Acceptance Form") will be required of these  
landowners. (PRINT ONLY) SIGNITURES ON PAGE 3

Downstream Landowner #1 Tom Freidel ✓

Downstream Landowner #2 Nancy Schoenfelder ✓

Downstream Landowner #3 Anthony Reiss ✓

Downstream Landowner #4 Kelly Doherty ✓

Downstream Landowner #5 \_\_\_\_\_

(list-add. If needed.) \_\_\_\_\_

If Outlet Drains into Road Right of Way, written approval is  
also required from the State, County and 2 signature's from  
Township Board for acknowledgement of project and/or other  
appropriate Government Agency.

If drainage enters another county in non-named ditch also need  
signature of downstream county Drainage Administrator.



DISCRIPTION of PROJECT

If open ditch, Length \_\_\_\_\_ Width \_\_\_\_\_ Depth \_\_\_\_\_

If Proposed Drainage Tile Length: \_\_\_\_\_ Lateral Length(s) \_\_\_\_\_

Tile Diameter Lateral 1) 4 in to 12 in to (largest)  
Long 1) \_\_\_\_\_ to \_\_\_\_\_ to (largest)

Approximate Area Contributing Runoff to Drain \_\_\_\_\_ Acres  
(43560sq ft = 1 Acre)

Proposed Finish: \_\_\_\_\_

Proposed Construction Start: \_\_\_\_\_

Drainage Contractor (if used) M.E.S Drainage, Inc.

Drainage Supervisor Jim Stofferan Phone 712 540-1294

Signature of Drainage (Landowner) Applicant: Shannon Southern & Bethem II  
by Mark J. Wipf

Applicant Mail Address: 43952 235 S t Winfred S.D.  
Cell 605-270-7421

Applicant Phone: 605-485-2236 Date: 6/03/25

Email Address: m1969mark@yahoo.com

Downstream Acceptance Forms Submitted Not Needed

Fee Paid \_\_\_\_\_

Signature Approving Authority Ronnie L. Cloth

Title Drainage Administrator Date 6-24-2025

Hanson County Drainage Permit Acceptance Form  
Waiver accepting proposed drainage project out letting on the  
property of \_\_\_\_\_ at (address) \_\_\_\_\_.

City \_\_\_\_\_ Hanson County, SD.

Legal Description Outlet \_\_\_\_\_  
(Describe to nearest 40 acres, e.g. NE1/4 NE1/4 10-103-58)

I am aware that \_\_\_\_\_ (upstream landowner is  
proposing to drain or construct a drainage system that will drain  
additional water downstream to my property. I have no objection to  
this project and I am aware of the impact that it may have on my  
property.

Date: \_\_\_\_\_

1 Signature: Tom Fritzel 6-4-25

Name Print: Tom Fritzel 6-4-25

2 Signature: Nancy Schwenfelder 6-4-25

Name Print: Nancy Schwenfelder 6-4-25

3 Signature: Anthony Riggs 6-4-25

Name Print: Anthony Riggs

4 Signature: Kelly Goldammer

Name Print: Kelly Goldammer

5 Signature of Drainage Applicant by Shannon Hutterigan Brethren INC  
Mark J. Wipf

(List- Add on if needed)

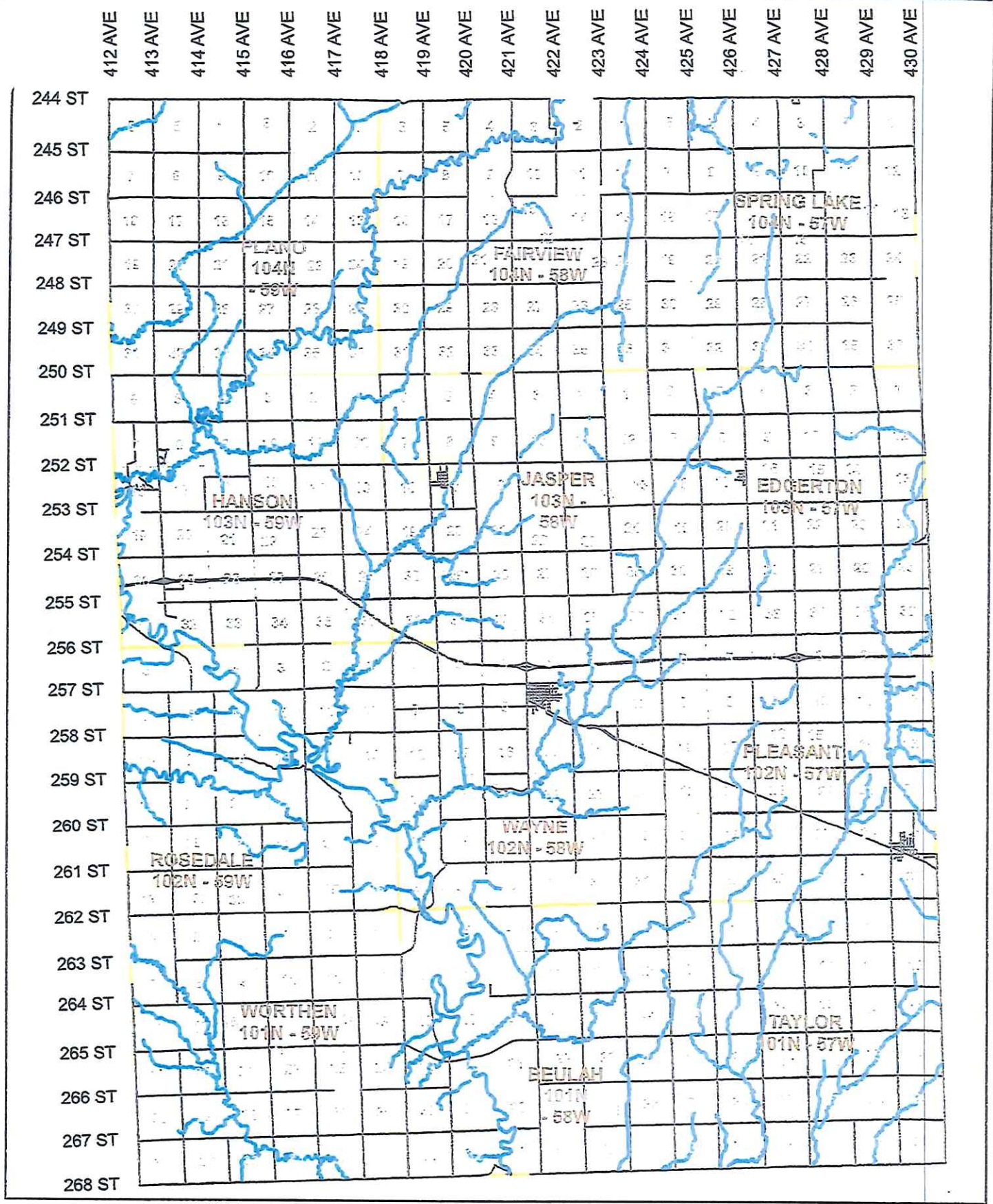
Applicant Address: 43932 235 St Winfred d. Dab

Applicant Phone: 605-485-2236 cell 605-270-7421

Above are all known downstream landowners from the outlet to the  
named watercourse.

This is not a permit. This is an acceptance form required from all  
downstream landowners whom the drainage may affect





HANSON COUNTY BLUE LINES - USGS

## DRAINAGE PERMIT APPLICATION CHECKLIST

For consideration of Permit # \_\_\_\_\_, the Drainage Board specifically finds that the proposed drainage:

- \_\_\_\_\_ (does) (does not) affect government property owned by a government
- \_\_\_\_\_ (does) (does not) drain a fish or wildlife lake
- \_\_\_\_\_ (does) (does not) impact a meandered lake
- \_\_\_\_\_ (does) (does not) affect another county
- \_\_\_\_\_ Converts noncontributing land to contributing land

### Flood hazards, floodplain values:

- \_\_\_\_\_ Erosion potential is \_\_\_\_\_
- \_\_\_\_\_ Impact on water quality and supply \_\_\_\_\_
- \_\_\_\_\_ Agricultural production will \_\_\_\_\_
- \_\_\_\_\_ Environmental quality \_\_\_\_\_
- \_\_\_\_\_ Aesthetics \_\_\_\_\_
- \_\_\_\_\_ Fish and wildlife values \_\_\_\_\_

### Downstream landowner considerations:

- \_\_\_\_\_ Receiving watercourse (does) (does not) have sufficient capacity
- \_\_\_\_\_ Drainage is a reasonable improvement and aid to the normal and natural system
- \_\_\_\_\_ Drainage is a reasonable artificial drain system
- \_\_\_\_\_ The amount of water proposed to be drained is (reasonable) (unreasonable)
- \_\_\_\_\_ The design and physical aspects of the drain are (acceptable) (unacceptable)
- \_\_\_\_\_ Impact of sustained flows is: \_\_\_\_\_

6/24/25

## DRAINAGE PERMIT APPLICATION CHECKLIST

For consideration of permit # \_\_\_\_\_, the Drainage Board specifically finds: that the proposed drainage:

- ☒ (does) (does not) affect government property owned by a government;
- ☒ (does) (does not) drain a fish or wildlife lake;
- ☒ (does) (does not) impact a meandered lake;
- ☒ (does) (does not) affect another county;
- ☒ Converts noncontributing land to contributing land. :

Flood hazards, floodplain values;

- ☒ Erosion potential is min;
- ☒ Impact on water quality and supply min;
- ☒ Agricultural production will improve;
- ☒ Environmental quality min;
- ☒ Aesthetics min;
- ☒ Fish and wildlife values none; and

Downstream landowner considerations:

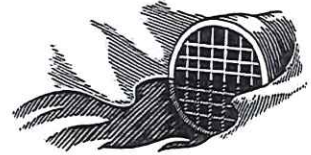
- ☒ Receiving watercourse (does) (does not) have sufficient capacity;
- ☒ Drainage is a reasonable improvement and aid to the normal and natural system;
- ☒ Drainage is a reasonable artificial drain system;
- ☒ The amount of water proposed to be drained is (reasonable) (unreasonable);
- ☒ The design and physical aspects of the drain are (acceptable) (unacceptable);
- ☒ Impact of sustained flows is: min.

Ronnie L. Orth  
6-24-2025





Davison County Planning & Zoning  
200 E. 4<sup>th</sup> Ave.  
Mitchell, SD 57301-2631  
Phone (605) 995-8615  
Fax (605) 995-8618



## Appendix A DAVISON COUNTY DRAINAGE APPLICATION

### I. Applicant(s):

Permit (Parcel) Number: 05000-10261-313-00

Name: Gerlach, Roger (owner) & Richard (applicant)

Date Filed with Register of Deeds: \_\_\_\_\_

Address: 26442 401<sup>st</sup> Ave. (Richard)  
Mt. Vernon, SD 57363

Date received: 1/22/25

Phone: Richard - 605-996-3027  
605-999-9022

Email: \_\_\_\_\_

Submitting Application to: ☐ Drainage Board ☒ Administrator for Administrative Approval

NOTE: This application must be accompanied by a detailed site plan, showing:

1. The location of the proposed drainage system; to include the inlet, outlet, & all drains.
2. The direction of the water flow.
3. The destination of water from the outlet, up to 1 mile.

Landowners affected will be notified by the Drainage Administrator. The Township Board Chairman will also be notified, and a copy of this application will be attached. For Administrative Approval, provide waivers (Appendix B) from landowners ½ mile upstream, 1 mile downstream, and a ¼ mile buffer on both sides of the drainage area.

List of all landowners ½ mile upstream, 1 mile downstream, and ¼ mile buffer on both sides:

NAME	ADDRESS	PHONE
1. <u>Roger Gerlach</u>	<u>P.O. Box 544. Salem. SD 57058</u>	
2. <u>William &amp; Dianne Neugebauer</u>	<u>40563 268<sup>th</sup> St., Dimock. SD 57331</u>	
3. <u>Randall W Miiller RLT</u>	<u>1801 Thomsen Place. Mitchell. SD</u>	
4. <u>Marlys M. Moege Estate</u>	<u>26941 400<sup>th</sup> Ave., Dimock. SD 57331</u>	
5. <u>Darrell &amp; Marilyn Mueller</u>	<u>P.O. Box 166. Mt. Vernon. SD 57363</u>	
6. <u>Doreen &amp; Roy Frusti</u>	<u>441 N. Hill St., Salem. SD 57058</u>	
7. <u>Elder &amp; Janelle Herman Living Trust</u>	<u>26121 401<sup>st</sup> Ave., Mt. Vernon. SD 57363</u>	
8. <u>FJ &amp; Cleora Roeder</u>	<u>40127 261<sup>st</sup> St., Mt. Vernon. SD 57363</u>	
9. <u>Mark &amp; Rebecca Klumb JRLT</u>	<u>26296 401<sup>st</sup> Ave., Mt. Vernon. SD 57363</u>	
10. <u>James Miiller</u>	<u>40235 263<sup>rd</sup> St., Ethan. SD 57334</u>	

BY SIGNING THIS APPLICATION, AS OWNER OF RECORD OF THE FOLLOWING PARCEL OF LAND FOR A DRAINAGE APPLICATION, ALLOWS PERMISSION TO THE DESIGNATED DRAINAGE ADMINISTRATOR TO ENTER UPON THE FOLLOWING PROPERTIES, FOR THE PURPOSE OF INSPECTION AND OBTAINING INFORMATION FOR THE ADMINISTRATIVE OR DRAINAGE COMMISSION'S DECISION. (INITIALS R. J.)

## II. Location

- Location of land to be drained:

SW ¼ of Sec 31 Twp 102 Rge 61 County of Davison, South Dakota

- Location of outlet end of proposed drain:

SW ¼ of Sec 31 Twp 102 Rge 61 County of Davison, South Dakota

Name or description (if any) of any watercourse, lake, slough, draw, natural drain-way, stream, creek, river, drain, or ditch that is involved in this application: The applicant would like to fill in about a half an acre of the ditch in the field to make it farmable. The applicant plans to bring in dirt to make the land farmable around and near the ditch. There is a dam on the property the water flows into, then naturally flows into an unnamed stream, eventually ending up into Twelve Mile Creek. The applicant has no intention of filling in the whole ditch, changing the flow of water, or stopping the water but routine maintenance is being performed.

- Any structures unable to be altered in the drainage path: N/A

## III. Description of Proposed Drainage System:

☐ Open Drainage Ditch

- Approximate size of area being drained (Acres): \_\_\_\_\_
- Elevation change from the inlet to the outlet (Feet): \_\_\_\_\_
- Bottom Width (Feet): \_\_\_\_\_
- Side Slope (Feet): \_\_\_\_\_
- Maximum Cut (Feet): \_\_\_\_\_
- Any boring under roadway: \_\_\_\_\_
- Explanation of Drain Design: \_\_\_\_\_

\_\_\_\_\_  
\_\_\_\_\_



- ☐ Closed Drainage Ditch (Underground drain tile)
- Approximate size of area being drained (Acres): \_\_\_\_\_
  - Elevation change from the inlet to the outlet (Feet): \_\_\_\_\_
  - Length of Solid Drain (Feet): \_\_\_\_\_
  - Length of Perforated Drain (Feet): \_\_\_\_\_
  - Total Length of all Drain (Feet): \_\_\_\_\_
  - Diameter(s) of Drain (Inches): \_\_\_\_\_
  - Any boring under roadway: \_\_\_\_\_
  - Explanation of Drain Design: \_\_\_\_\_

- ☐ Other Type of Drainage Ditch:
- Approximate size of area being drained (Acres): \_\_\_\_\_
  - Elevation change from the inlet to the outlet (Feet): \_\_\_\_\_
  - Any boring under roadway: \_\_\_\_\_
  - Explanation of Drain Design: \_\_\_\_\_
- \_\_\_\_\_
- \_\_\_\_\_
- \_\_\_\_\_

IV. **South Dakota One Call Locate Date:** \_\_\_\_\_

V. **General Considerations:**

State any facts or reasons you believe are pertinent to the proposed drainage system that may assist the Administrator or Board in consideration of this application. \_\_\_\_\_

\_\_\_\_\_

VI. **Required Signatures:**

If the drainage system allows water to enter a Road Right of Way, a signature from the appropriate Road Authority is also required. This includes Township, County, and State roads.

\_\_\_\_\_  
Road Authority Signature

Applicant/Owner Notarized Signature

STATE OF SOUTH DAKOTA )  
 ) SS  
COUNTY OF DAVISON )

On this 22nd day of January, 2025, before me, the undersigned officer, personally appeared Richard Horbach, known to me or satisfactorily proven to be the person whose name is subscribed to the within instrument and acknowledge that he executed the same for the purposes therein contained.

In Witness Whereof, I hereunto set my hand and seal.



Karen Knadle  
Notary Public

4/24/30  
My Commission Expires

Richard Horbach  
Applicant Renter Notarized Signature

STATE OF SOUTH DAKOTA )  
 ) SS  
COUNTY OF DAVISON )

On this \_\_\_\_\_ day of \_\_\_\_\_, \_\_\_\_\_, before me, the undersigned officer, personally appeared \_\_\_\_\_, known to me or satisfactorily proven to be the person whose name is subscribed to the within instrument and acknowledge that he executed the same for the purposes therein contained.

In Witness Whereof, I hereunto set my hand and seal.

(Seal)

\_\_\_\_\_  
Notary Public

\_\_\_\_\_  
My Commission Expires

Contractor Notarized Signature

STATE OF SOUTH DAKOTA )  
 ) SS  
COUNTY OF DAVISON )

On this \_\_\_\_\_ day of \_\_\_\_\_, \_\_\_\_\_, before me, the undersigned officer, personally appeared \_\_\_\_\_, known to me or satisfactorily proven to be the person whose name is subscribed to the within instrument and acknowledge that he executed the same for the purposes therein contained.

In Witness Whereof, I hereunto set my hand and seal.

(Seal)

\_\_\_\_\_  
Notary Public

\_\_\_\_\_  
My Commission Expires

VII. Administrator or Drainage Board Decision:

This Application to drain is hereby:

☒ Approved

☐ Disapproved

Date: 1-22-25

Attached hereto and incorporated herein are special conditions on this permit:

This application can be heard under Section 2:03 Regular Permits Required.

Karen Weglitz

Planning & Zoning Administrator

\_\_\_\_\_  
Drainage Commission Chairperson

\_\_\_\_\_  
County Auditor

