



To Access Property in the County

1. Go to <https://www.davisonreports.com/>. Click on the  button.
2. In the top right corner of the map, you will see a set of options. Click on the , then set the option to Imagery (will see buildings and grass) or streets.
3. Click on the  (layers) option, then check what layers you would like on your map.
4. There are also other options, such as a measuring tool.
5. If you would like parcel information, click on the parcel. A blue box will highlight the parcel and the property information will pop up. If you want more details on the property, click on the [More info](#) link.

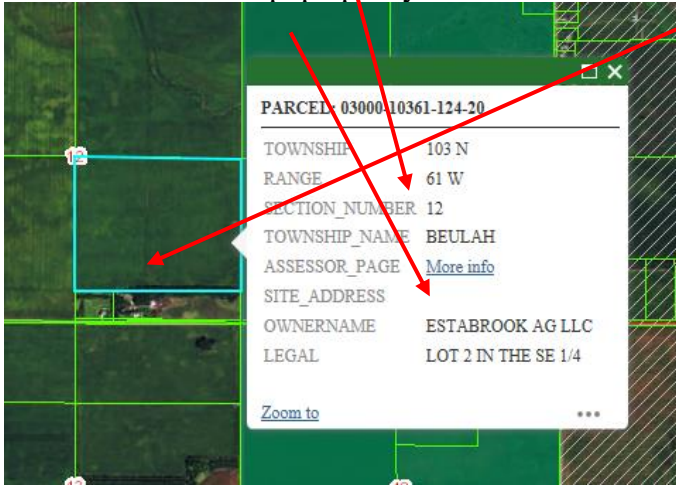

6. This will show you most information the county has on the property, as shown in the example below.

Parcel ID	15620-00200-007-00		
Current Owner	JONES MICHAELA R & ADAM T		
Mailing Address	500 E 11TH AVE		
	City MITCHELL	State SD	Zip 57301
Property Address	500 E 11TH AVE MITCHELL SD		
Legal Description	D A SCOTTS 2ND ADDN-SE(15) LOT 7 BLK 2		
School District	MITCHELL 17-2	Fire District	F03

Valuation Information

AG Land Class	AG Land Value	AG Acres
	\$ 0	0
AG Building Class	AG Building Value	
	\$ 0	
NON-AG Land Class	NON-AG Land Value	NON-AG Acres
D-S	\$ 7,950	0
NON-AG Building Class	NON-AG Building Value	
D1-S	\$ 131,495	
NON-AG Other Building Class	NON-AG Other Building Value	
	\$ 0	

Structure Details

Year Built	1948	Stories	1
Total Structure SF	1,428	Main Floor SF	1,428
Basement SF	988	Basement Finish SF	889
Bedrooms	0	Bathrooms	1
Siding	WOOD	Roof	COMPOSITION
HVAC	W/C		
Garage Type		Garage Size	
Lot Size	50 X 142		
Enclosed Porch		Roofed Entry/Porch	30
Wood Deck		Roofed Wood Deck	
Additional Information			

Register of Deeds Office-Last Deed

Filed Date	Book	Page
11\12	612	545

Last Sale Information

This section under construction		
---------------------------------	--	--